



# FOCUS ON INJECTION MOLDING AUTOMATION

专注于注塑自动化

PRODUCT CATALOG





## FOCUS ON INJECTION MOLDING AUTOMATION

SWITEK™

The Best Choice For Injection Molding Automation

# FOCUS ON INJECTION MOLDING AUTOMATION

FOCUS ON  
THE FIELD OF INJECTION MOLDING AUTOMATION  
FOR 16 YEARS WITH CORE TECHNOLOGY

PRODUCT CATALOG

## WE ONLY DO INJECTION MOLDING AUTOMATION

We specialize in injection molding automation, SWITEK has been focusing on the R&D and manufacturing of automation equipment for 16 years. We can provide injection molding automation equipment and its one-stop injection molding solutions. **SWITEK is the first chinese enterprise to master the core technology of IML robot, the first chinese enterprise to realize automatic packaging of knives, forks and spoons, and the first chinese enterprise to realize picking up 64 cavities forks and then folding forks. SWITEK provided intelligent injection molding solutions for hundreds of famous enterprises in more than 60 countries around the world.**

## WHAT SWITEK CAN DO FOR YOU?

According to the different needs of customers, SWITEK's products can be customized. SWITEK equipment can help you improve production efficiency, reduce labor costs and improve profitability. meantime, it can effectively improve the production flexibility. Besides, SWITEK products have been updated and iterated for 16 years, **SWITEK robot can work with different brands of Injection machines from 30ton to 7000ton clamping force.** If you want to improve production efficiency through automation, SWITEK is your best choice.



# SWITEK ROBOT MODELS

**01** **SW8**  
High Speed In-Mould  
Labeling System(IML)



**03** **SW7112DS**  
High Speed  
Three Axis Servo Robot



**05** **SW75**  
Middle-Size  
Three Axis Servo Robot



**07** **SW77**  
Large-Size  
Three Axis Servo Robot



**09** **SW63S**  
Three Axis Servo  
Robot



**11** **SW63DS**  
Three Axis Servo  
Robot



**13** **SW63**  
Five Axis Servo  
Robot



**15** **SW63D**  
Five Axis Servo  
Robot

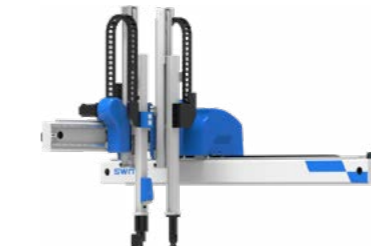

**17** **SW67DS**  
Three Axis Servo  
Robot

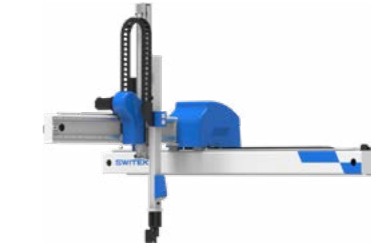

**21** **SW67D**  
Five Axis Servo  
Robot



FOCUS ON  
INJECTION MOLDING  
AUTOMATION

# SW8 IML SYSTEM

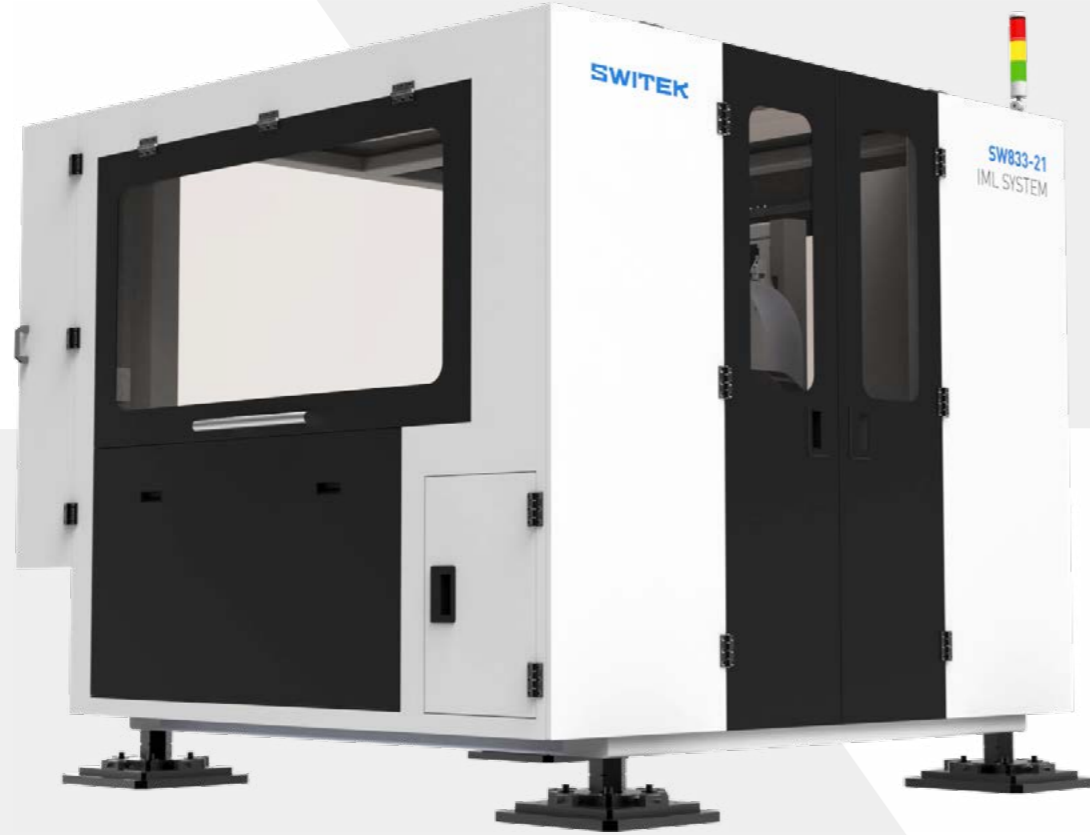

# SPECIFICATION

SERVO  
**AC**

<b>X1</b>	<b>X2</b>	<b>Y</b>
190mm	190mm	400mm
<b>Z</b>	<b>L</b>	<b>W</b>
2100mm	2800mm	2245mm
<b>A</b>	<b>B</b>	<b>H</b>
1280mm	2450mm	2250mm

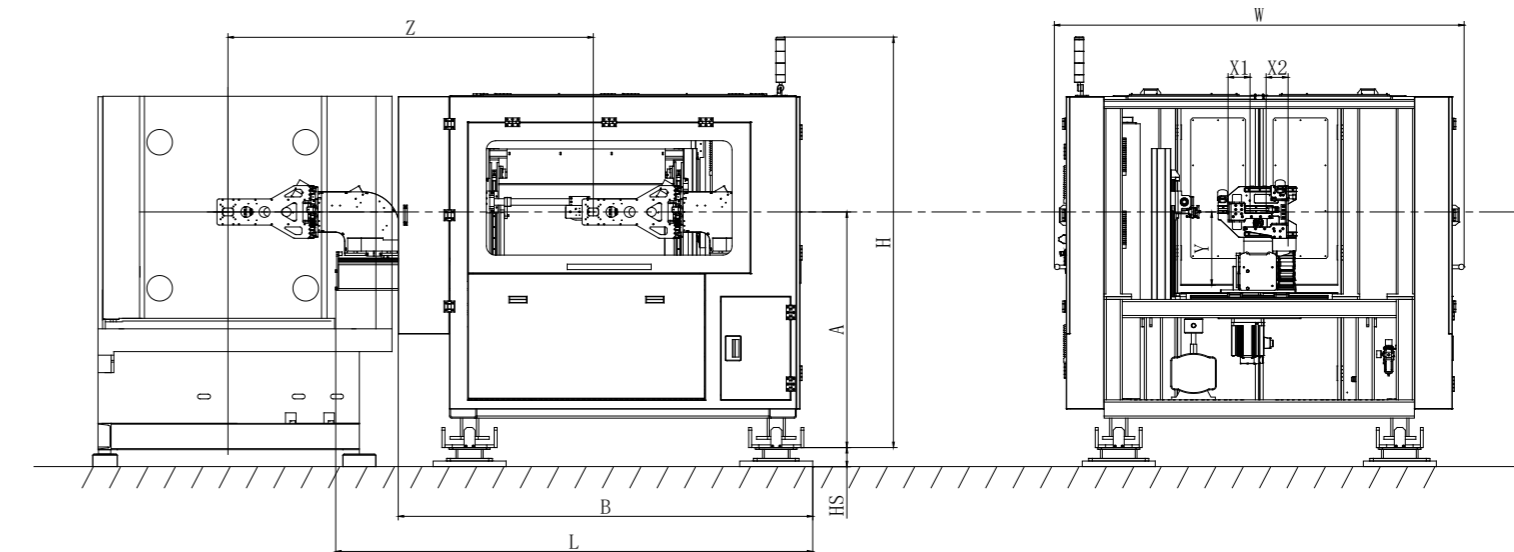

# SW7112DS

## THREE AXIS SERVO ROBOT

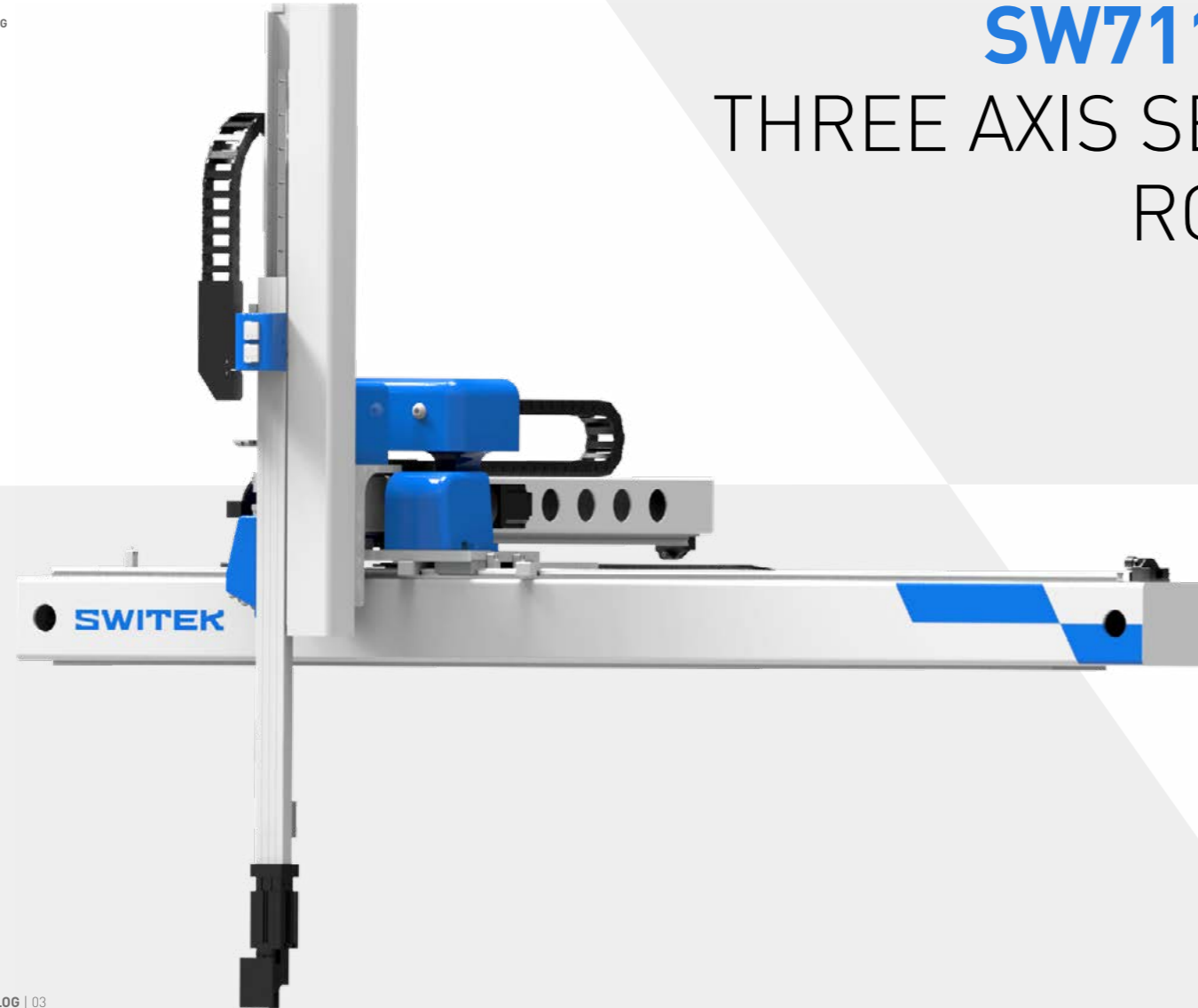

# SW7112DS

## SPECIFICATION

AXIS

03

SERVO

AC

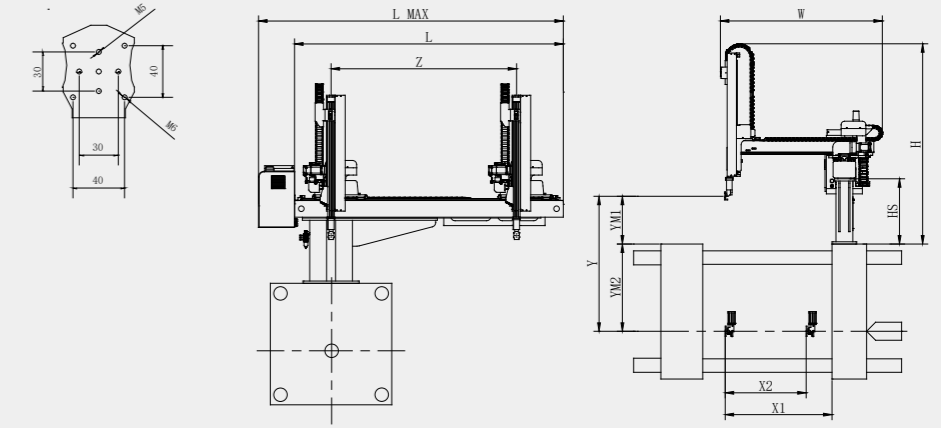

Recommended IMM (Ton)	200-550	Reference Base Height Hs(mm)	580	AC IN PUT (V)	AC220
Traverse Stroke Z (mm)	1650	Servo Driver/Motor X	750w	Power(KVA)	3(Single Phase)
Vertical Stroke Y (mm)	1200	Servo Driver/Motor Y	1000W	Working Pressure(kgf/cm <sup>2</sup> )	5 ~ 7
Crosswise Stroke X2 (mm)	720	Servo Driver/Motor Z	750w	Air Consumption(NL/cycle)	2
Furthest Position Of Main Arm X1(mm)	950	Vacuum	2	Language Selection	中 /EN/Other
Deputy Arm Stroke X4(mm)	-	Chuck pipe	2	Net Weight(kg)	370
Nearest Position Of Secondary Arm X5(mm)	-	Take Out Time(Sec)	0.8	Gross Weight(kg)	400
Standby Height YM1(mm)	425	Max Load (kg)	5	Robot Size (L MAXxWxH)mm	2710x1434x1780mm
Vertical Stroke YM2(mm)	775	Dry Cycle Time(Sec)	3.3	Package Size (LxWxH)mm	3100x1600x1800mm

# SW75 THREE AXIS SERVO ROBOT

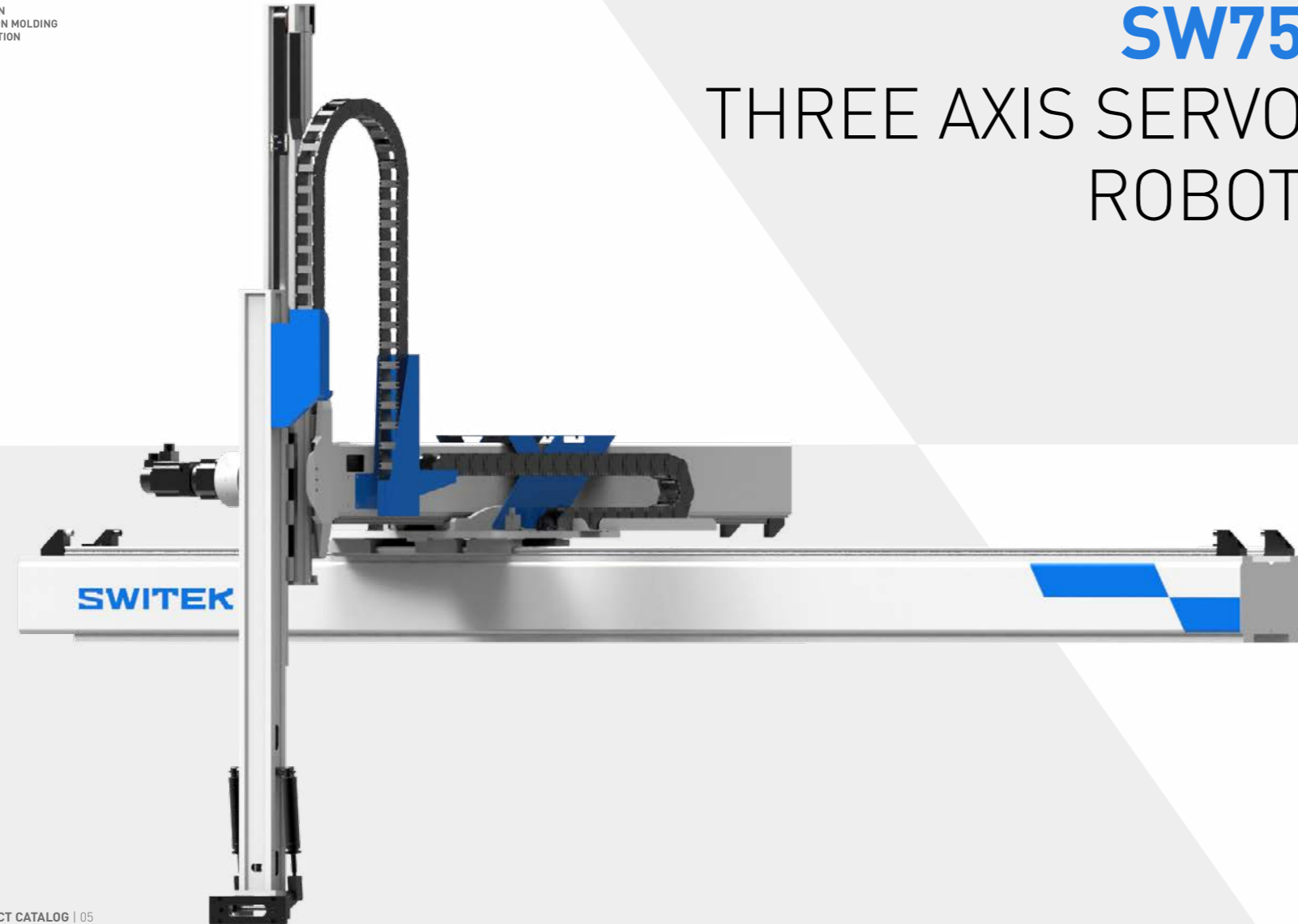

## SW75 Series SPECIFICATION

AXIS

**03**

SERVO

**AC**

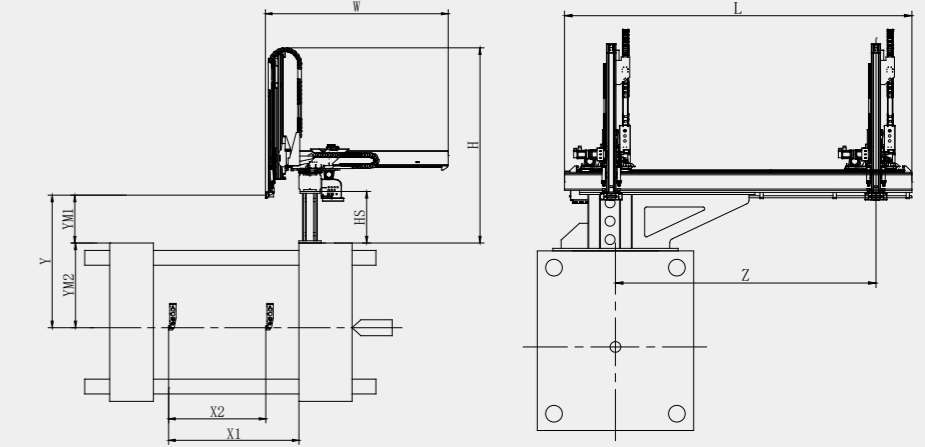

### SW7518DS/**SW7522DS**

Recommended IMM (Ton)	500-1800	Reference Base Height Hs(mm)	700	AC IN PUT (V)	AC220
Traverse Stroke Z (mm)	3120	Servo Driver/Motor X	2000W	Power(KVA)	9/ <b>11.4</b> (Three Phase)
Vertical Stroke Y (mm)	1800/ <b>2200</b>	Servo Driver/Motor Y	2000W	Working Pressure(kgf/cm <sup>2</sup> )	5 ~ 7
Crosswise Stroke X2 (mm)	1320/ <b>1680</b>	Servo Driver/Motor Z	2000W	Air Consumption(NL/cycle)	4.5/ <b>5</b>
Furthest Position Of Main Arm X1(mm)	1770/ <b>2130</b>	Vacuum	2	Language Selection	中 /EN/Other
Optional AC Axis	A/B/C	Chuck pipe	2	Net Weight(kg)	1500/ <b>1515</b>
Maximum Rotation Angle Of Servo Shaft	AB:270° C:180°	Take Out Time(Sec)	3.5/ <b>3.8</b>	Gross Weight(kg)	1540/ <b>1555</b>
Standby Height YM1(mm)	650	Max Load (kg)	15	Robot Size (LxWxH)mm	4160x2480x2650 / <b>4160x2850x2830</b>
Vertical Stroke YM2(mm)	1150/ <b>1550</b>	Dry Cycle Time(Sec)	12	Package Size (LxWxH)mm	4500*2200*1600



# SW77

## THREE AXIS SERVO ROBOT

# SW77 Series

## SPECIFICATION

AXIS

**03**

SERVO

**AC**

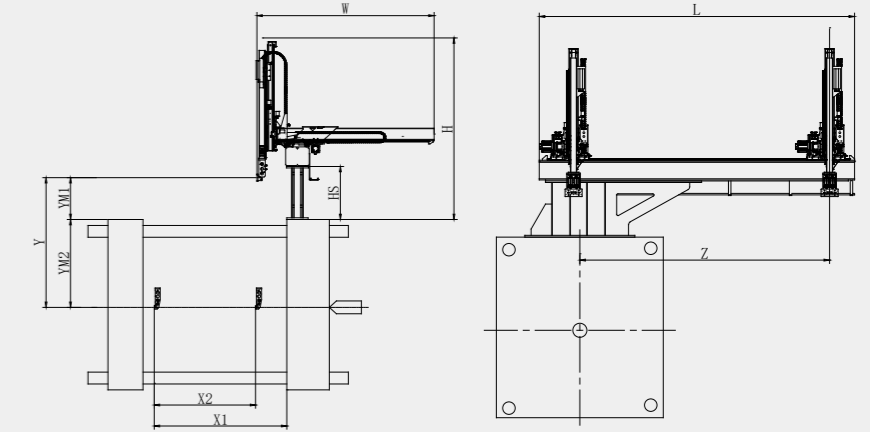

### SW7725DS/**SW7730DS**

Recommended IMM (Ton)	1000-4000	Reference Base Height Hs(mm)	900	AC IN PUT (V)	AC220
Traverse Stroke Z (mm)	4000	Servo Driver/Motor X	2000W	Power(KVA)	12.8/ <b>14.6</b> (Three Phase)
Vertical Stroke Y (mm)	2500/ <b>3000</b>	Servo Driver/Motor Y	3000W/ <b>5000W</b>	Working Pressure(kgf/cm <sup>2</sup> )	5 ~ 7
Crosswise Stroke X2 (mm)	1720	Servo Driver/Motor Z	3000w	Air Consumption(NL/cycle)	8/2
Furthest Position Of Main Arm X1(mm)	2250	Vacuum	2	Language Selection	中 /EN/Other
Deputy Arm Stroke X4(mm)	-	Chuck pipe	2	Net Weight(kg)	2025/ <b>2055</b>
Nearest Position Of Secondary Arm X5(mm)	-	Take Out Time(Sec)	4.5/ <b>6</b>	Gross Weight(kg)	2065/ <b>2095</b>
Standby Height YM1(mm)	710	Max Load (kg)	50/ <b>75</b>	Robot Size (LxWxH)mm	5050x3005x3200 / <b>5050x3005x3440</b>
Vertical Stroke YM2(mm)	1790/ <b>2290</b>	Dry Cycle Time(Sec)	16	Package Size (LxWxH)mm	5500x2200x1600mm



# SW63S THREE AXIS SERVO ROBOT

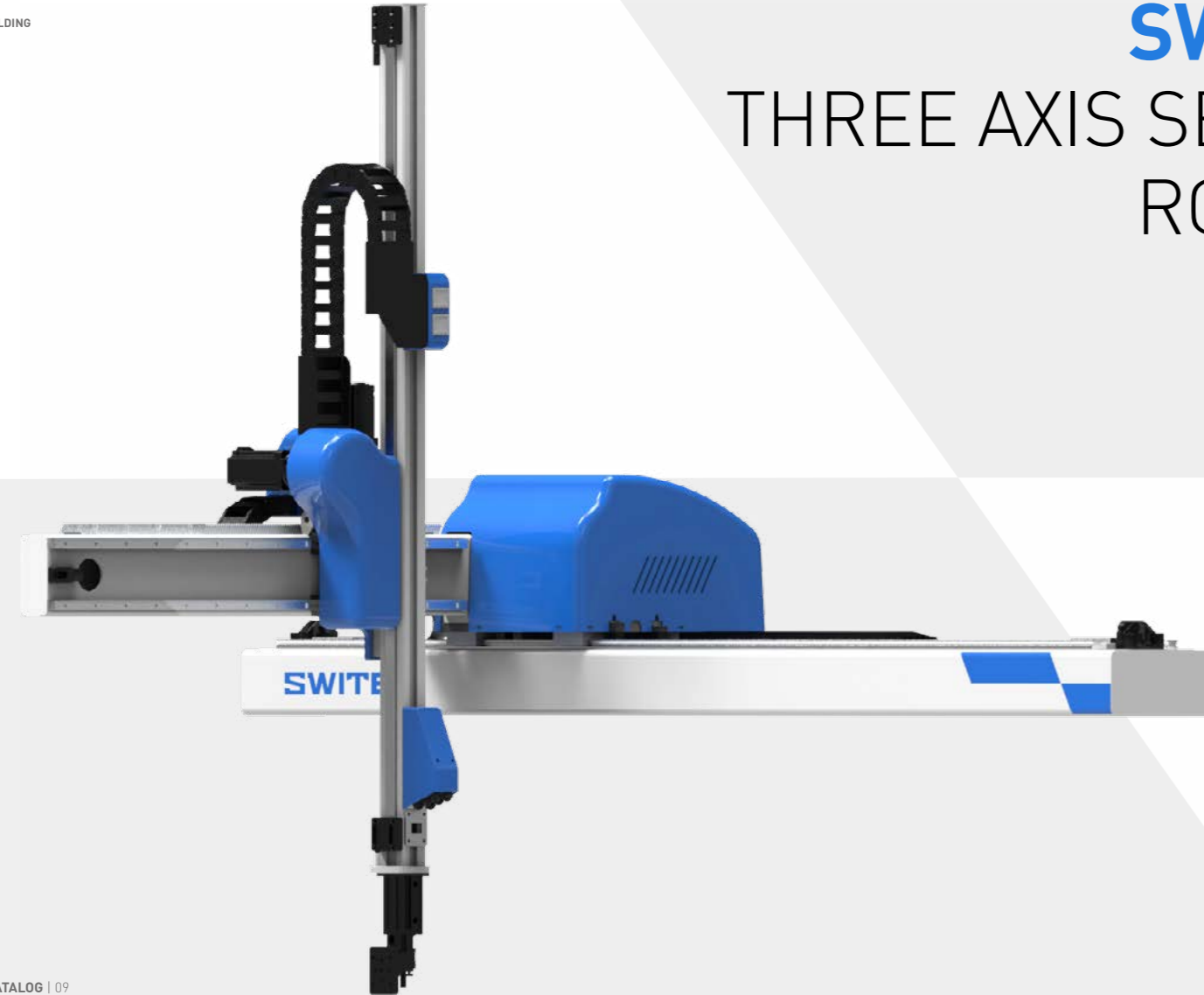

## SW63S Series SPECIFICATION

AXIS

**03**

SERVO

**AC**

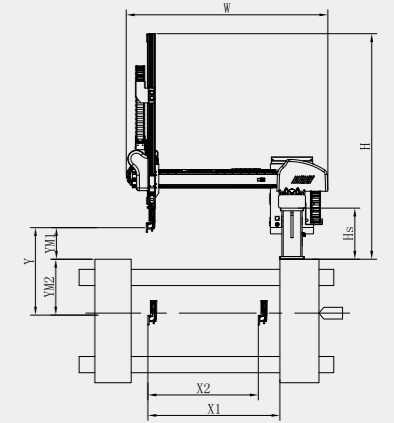
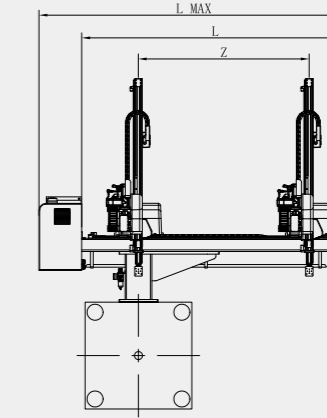
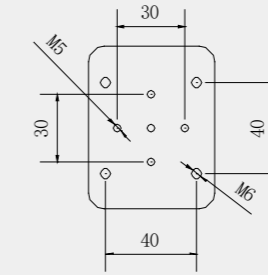

### SW6308S-20/SW6310S-20

Recommended IMM (Ton)	50-350	Reference Base Height Hs(mm)	380	AC IN PUT (V)	AC220
Traverse Stroke Z (mm)	1280/ <b>1580</b>	Servo Driver/Motor X	400W	Power(KVA)	1.8(Single Phase)
Vertical Stroke Y (mm)	800/ <b>1000</b>	Servo Driver/Motor Y	400W	Working Pressure(kgf/cm <sup>2</sup> )	5 ~ 7
Crosswise Stroke X2 (mm)	820	Servo Driver/Motor Z	400w	Air Consumption(NL/cycle)	2
Furthest Position Of Main Arm X1(mm)	980	Vacuum	2	Language Selection	中 /EN/Other
Deputy Arm Stroke X4(mm)	-	Chuck pipe	2	Net Weight(kg)	360/ <b>380</b>
Nearest Position Of Secondary Arm X5(mm)	-	Take Out Time(Sec)	2	Gross Weight(kg)	390/ <b>410</b>
Standby Height YM1(mm)	235	Max Load (kg)	3	Robot Size (L MAXxWxH)mm	2320x1500x1690 / <b>2640x1500x1930</b>
Vertical Stroke YM2(mm)	565/ <b>765</b>	Dry Cycle Time(Sec)	6	Package Size (LxWxH)mm	2800x1600x1800mm

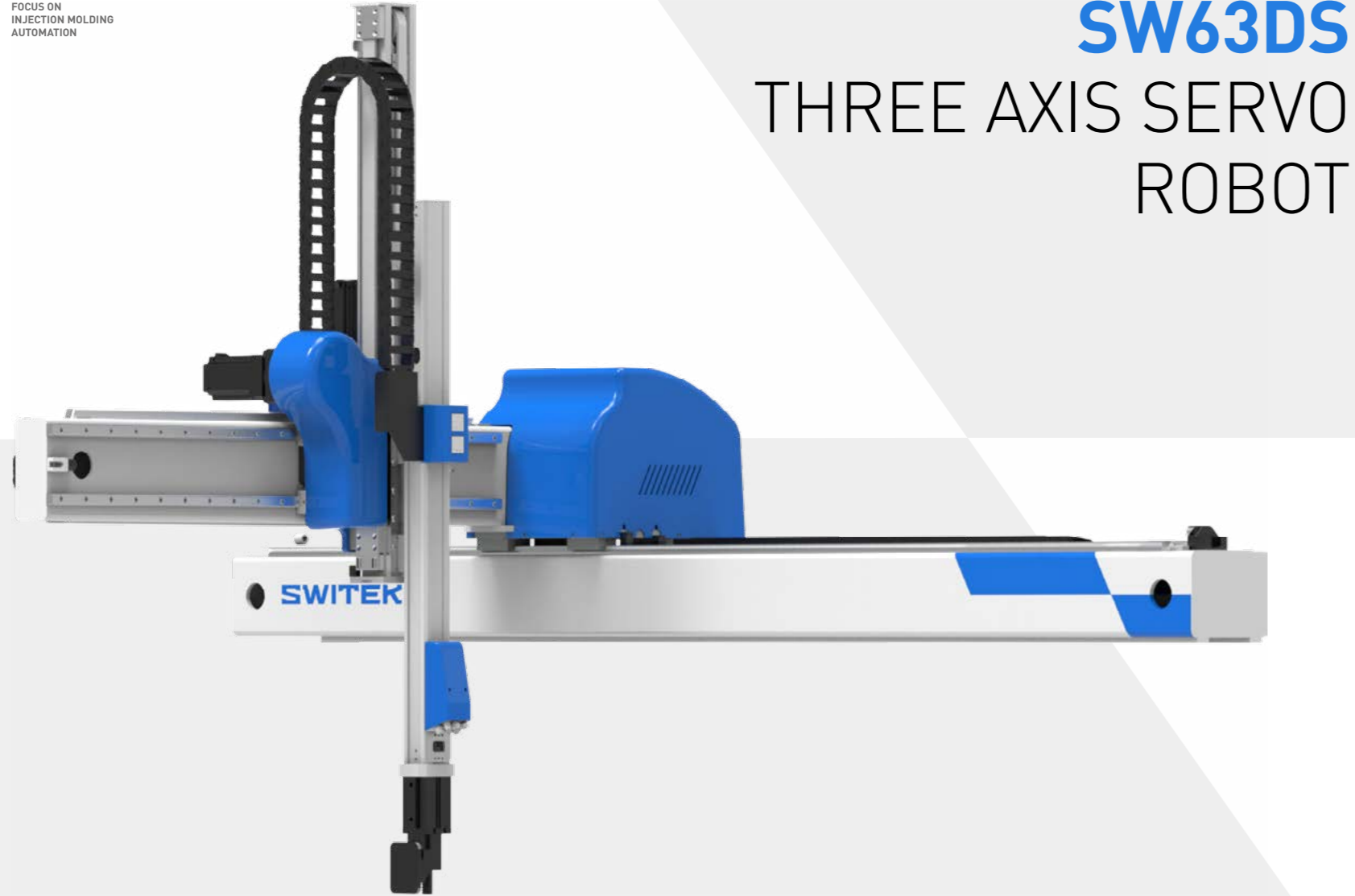

# SW63DS

## THREE AXIS SERVO ROBOT

# SW63DS Series

## SPECIFICATION

AXIS

03

SERVO

AC

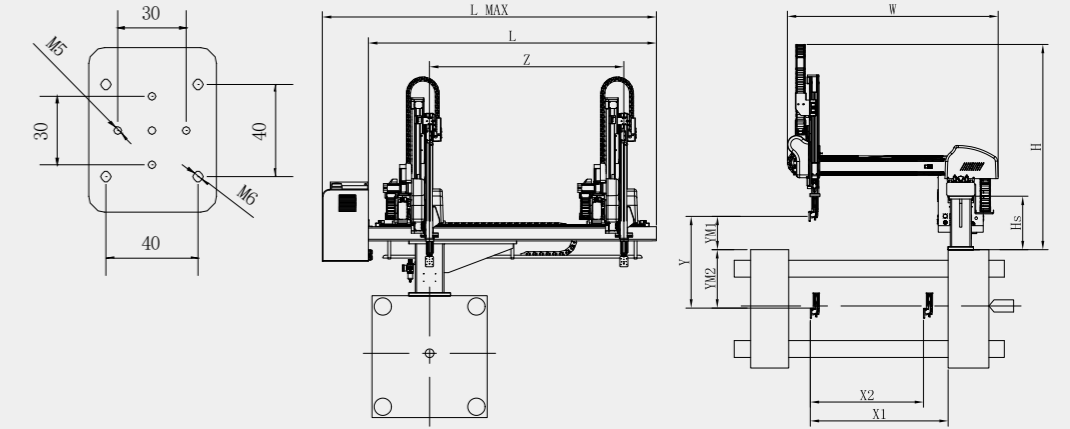

### SW6308DS-20/SW6310DS-20

Recommended IMM (Ton)	50-350	Reference Base Height Hs(mm)	380	AC IN PUT (V)	AC220
Traverse Stroke Z (mm)	1350/ <b>1650</b>	Servo Driver/Motor X	400W	Power(KVA)	1.8(Single Phase)
Vertical Stroke Y (mm)	800/ <b>1000</b>	Servo Driver/Motor Y	400W	Working Pressure(kgf/cm <sup>2</sup> )	5-7
Crosswise Stroke X2 (mm)	800/ <b>805</b>	Servo Driver/Motor Z	400w	Air Consumption(NL/cycle)	2
Furthest Position Of Main Arm X1(mm)	980	Vacuum	2	Language Selection	中 /EN/Other
Deputy Arm Stroke X4(mm)	-	Chuck pipe	2	Net Weight(kg)	360/ <b>380</b>
Nearest Position Of Secondary Arm X5(mm)	-	Take Out Time(Sec)	2	Gross Weight(kg)	390/ <b>410</b>
Standby Height YM1(mm)	235/ <b>385</b>	Max Load (kg)	3	Robot Size (L MAXxWxH)mm	2320x1500x1460 <b>/2640x1500x1580</b>
Vertical Stroke YM2(mm)	565/ <b>615</b>	Dry Cycle Time(Sec)	6	Package Size (LxWxH)mm	2800X1600X1800

# SW63

## FIVE AXIS SERVO ROBOT

# SW63 Series

## SPECIFICATION

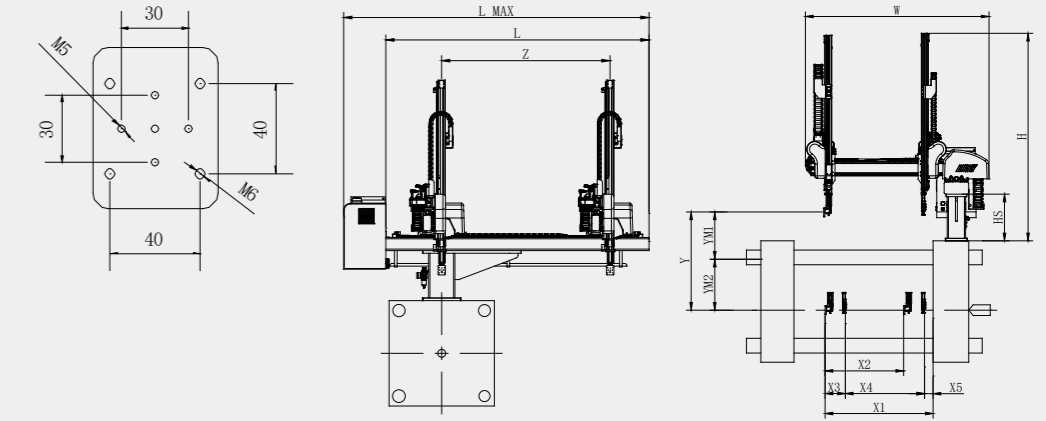

AXIS

05

SERVO

AC



### SW6308-20/SW6310-20

Recommended IMM (Ton)	50-350	Reference Base Height Hs(mm)	380	AC IN PUT (V)	AC220
Traverse Stroke Z (mm)	1280/ <b>1580</b>	Servo Driver/Motor X	400x2W	Power(KVA)	2.5(Single Phase)
Vertical Stroke Y (mm)	800/ <b>1000</b>	Servo Driver/Motor Y	400x2W	Working Pressure(kgf/cm <sup>2</sup> )	5-7
Crosswise Stroke X2 (mm)	640	Servo Driver/Motor Z	400w	Air Consumption(NL/cycle)	3
Furthest Position Of Main Arm X1(mm)	880	Vacuum	2	Language Selection	中 /EN/Other
Deputy Arm Stroke X4(mm)	645	Chuck pipe	2	Net Weight(kg)	390/ <b>410</b>
Nearest Position Of Secondary Arm X5(mm)	70	Take Out Time(Sec)	2	Gross Weight(kg)	420/ <b>440</b>
Standby Height YM1(mm)	235	Max Load (kg)	3	Robot Size (L MAXxWxH)mm	2320x1500x1690 <b>/2640x1500x1930</b>
Vertical Stroke YM2(mm)	565/ <b>765</b>	Dry Cycle Time(Sec)	6	Package Size (LxWxH)mm	2800x1600x1800

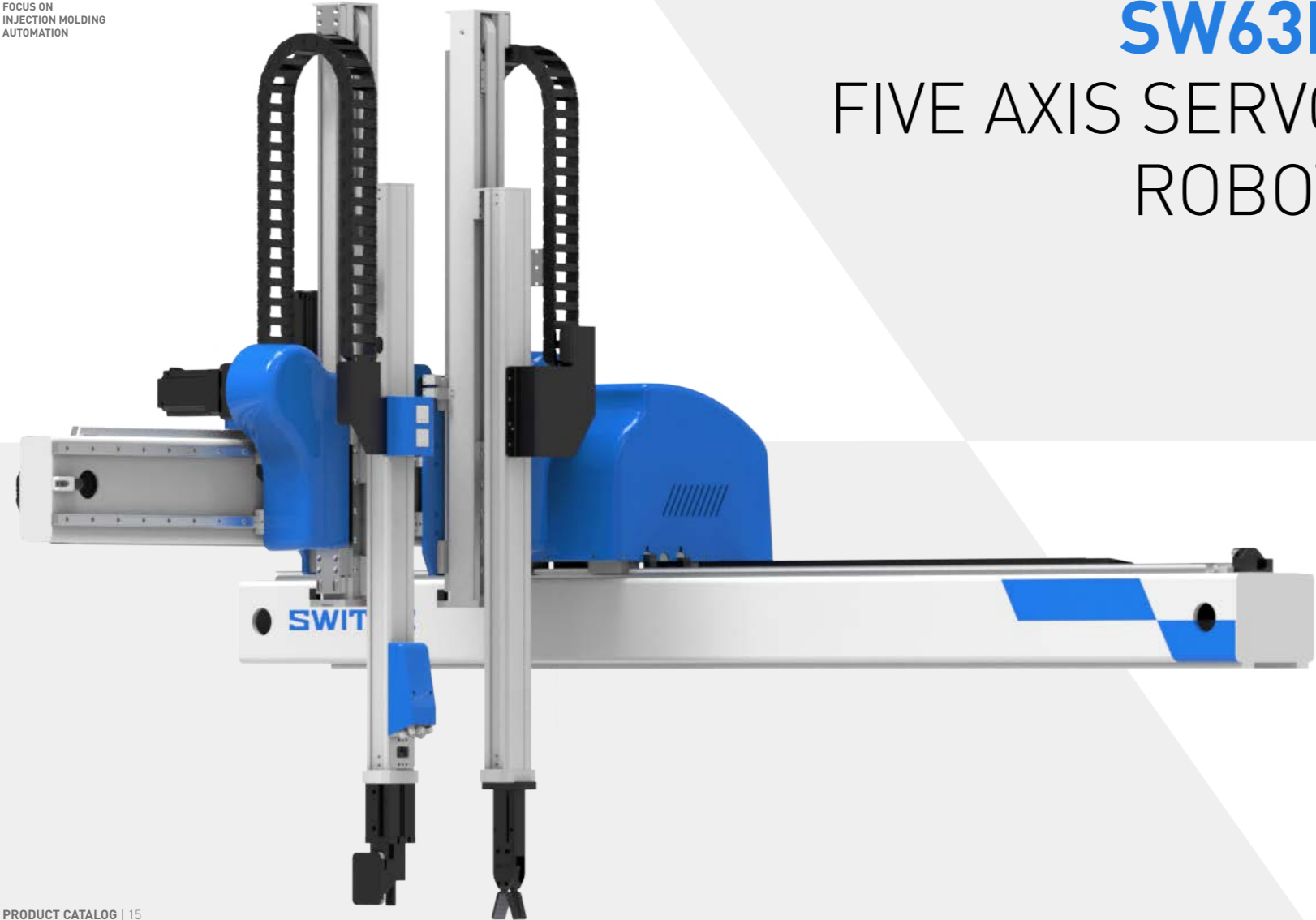

# SW63D

## FIVE AXIS SERVO ROBOT

# SW63D Series

## SPECIFICATION

AXIS

**05**

SERVO

**AC**

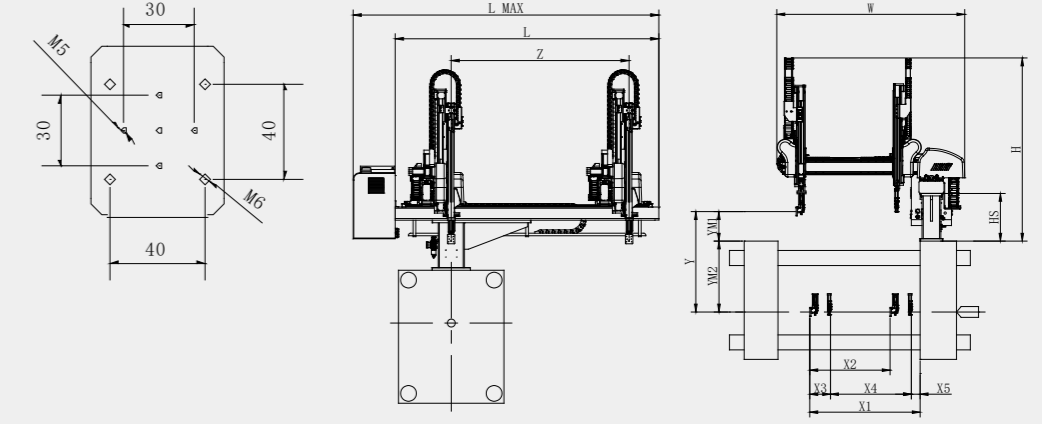

### SW6308D-20/SW6310D-20

Recommended IMM (Ton)	50-350	Reference Base Height Hs(mm)	380	AC IN PUT (V)	AC220
Traverse Stroke Z (mm)	1350/ <b>1650</b>	Servo Driver/Motor X	400x2W	Power(KVA)	2.5(Single Phase)
Vertical Stroke Y (mm)	800/ <b>1000</b>	Servo Driver/Motor Y	400x2W	Working Pressure(kgf/cm <sup>2</sup> )	5-7
Crosswise Stroke X2 (mm)	640	Servo Driver/Motor Z	400w	Air Consumption(NL/cycle)	3
Furthest Position Of Main Arm X1(mm)	880	Vacuum	2	Language Selection	中 /EN/Other
Deputy Arm Stroke X4(mm)	645	Chuck pipe	2	Net Weight(kg)	390/ <b>410</b>
Nearest Position Of Secondary Arm X5(mm)	70	Take Out Time(Sec)	2	Gross Weight(kg)	420/ <b>440</b>
Standby Height YM1(mm)	385	Max Load (kg)	3	Robot Size (L MAXxWxH)mm	2320x1500x1460 <b>/2640x1500x1580</b>
Vertical Stroke YM2(mm)	415	Dry Cycle Time(Sec)	6	Package Size (LxWxH)mm	2800x1600x1800

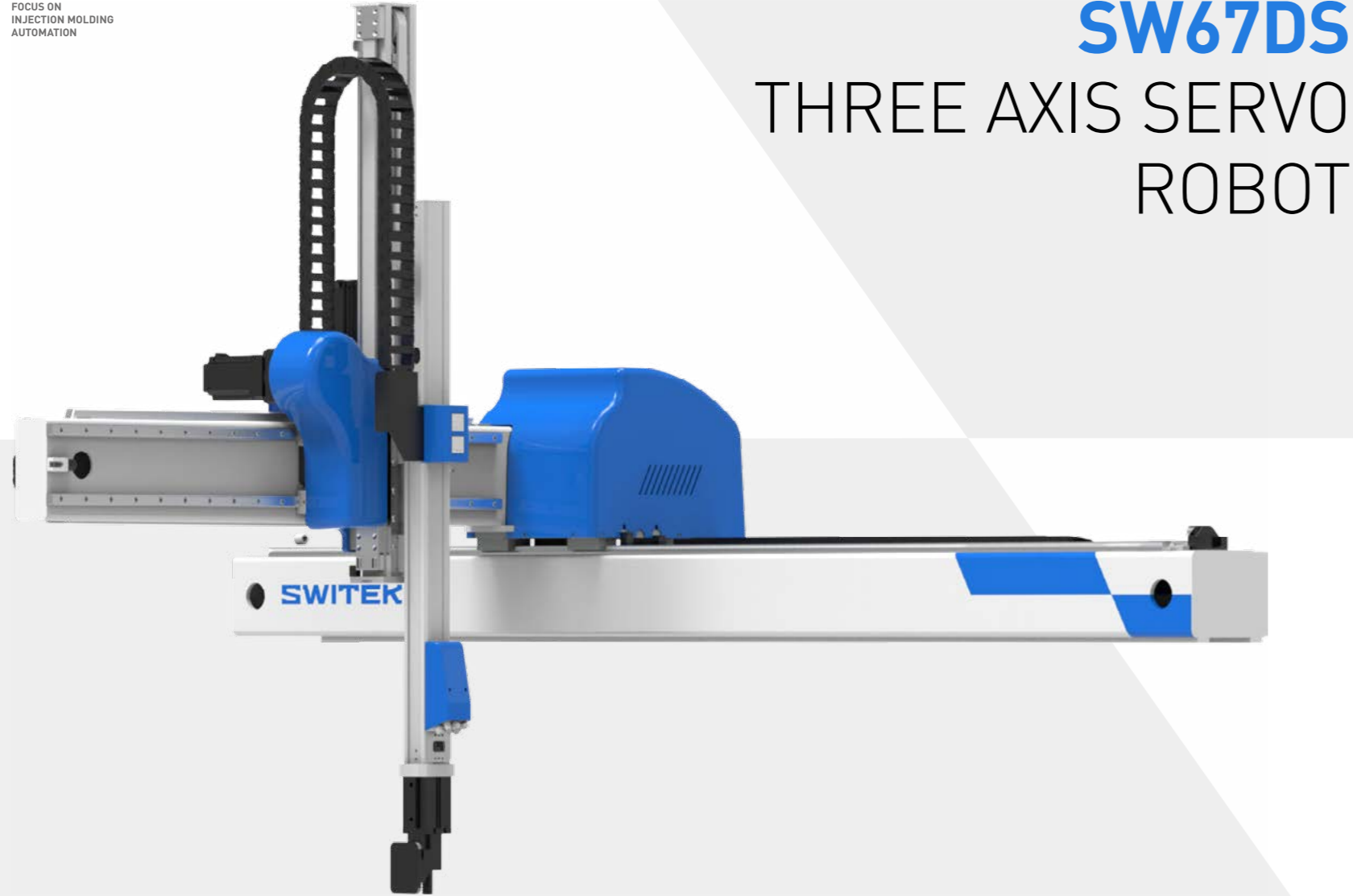

# SW67DS

## THREE AXIS SERVO ROBOT

# SW6710DS-20

## SPECIFICATION

AXIS

**03**

SERVO

**AC**

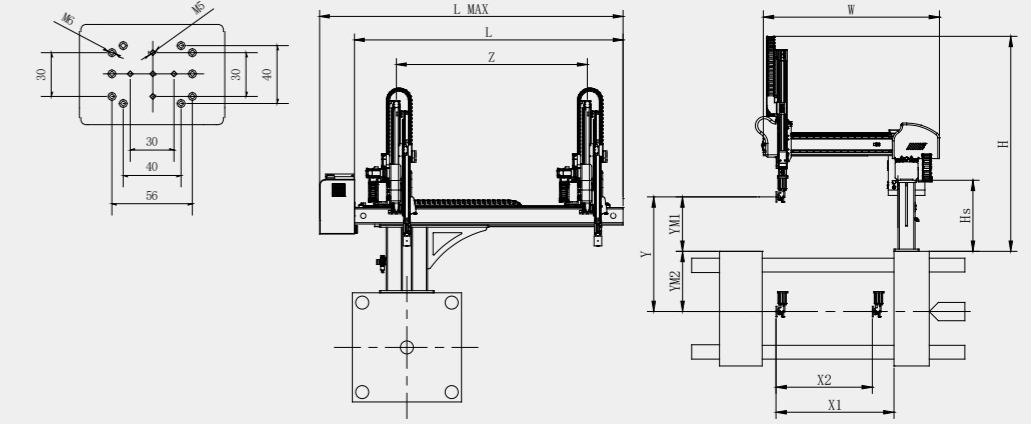

Recommended IMM (Ton)	150-400	Reference Base Height Hs(mm)	620	AC IN PUT (V)	AC220
Traverse Stroke Z (mm)	1750	Servo Driver/Motor X	400W	Power(KVA)	2.5(Single Phase)
Vertical Stroke Y (mm)	1000	Servo Driver/Motor Y	750W	Working Pressure(kgf/cm <sup>2</sup> )	5-7
Crosswise Stroke X2 (mm)	840	Servo Driver/Motor Z	750w	Air Consumption(NL/cycle)	2.5
Furthest Position Of Main Arm X1(mm)	1025	Vacuum	2	Language Selection	中 /EN/Other
Deputy Arm Stroke X4(mm)	-	Chuck pipe	2	Net Weight(kg)	500
Nearest Position Of Secondary Arm X5(mm)	-	Take Out Time(Sec)	3	Gross Weight(kg)	530
Standby Height YM1(mm)	475	Max Load (kg)	8	Robot Size (L MAXxWxH)mm	2780X1610X1930
Vertical Stroke YM2(mm)	525	Dry Cycle Time(Sec)	7	Package Size (LxWxH)mm	3200X1800X2000

# SW6712DS-20

## SPECIFICATION

AXIS

03

SERVO

AC

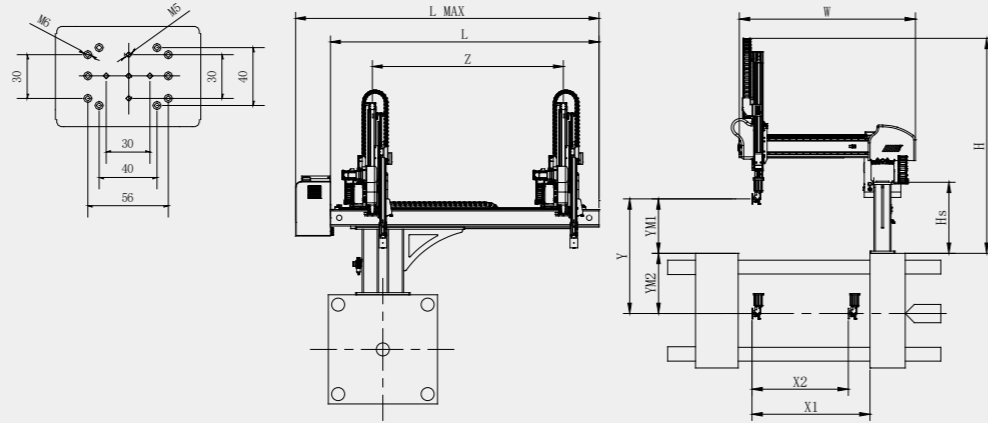

Recommended IMM (Ton)	350-650	Reference Base Height Hs(mm)	620	AC IN PUT (V)	AC220
Traverse Stroke Z (mm)	2000	Servo Driver/Motor X	400W	Power(KVA)	2.5(Single phase)
Vertical Stroke Y (mm)	1200	Servo Driver/Motor Y	750W	Working Pressure(kgf/cm <sup>2</sup> )	5-7
Crosswise Stroke X2 (mm)	840	Servo Driver/Motor Z	750w	Air Consumption(NL/cycle)	2.5
Furthest Position Of Main Arm X1(mm)	1025	Vacuum	2	Language Selection	中 /EN/Other
Deputy Arm Stroke X4(mm)	-	Chuck pipe	2	Net Weight(kg)	520
Nearest Position Of Secondary Arm X5(mm)	-	Take Out Time(Sec)	3	Gross Weight(kg)	550
Standby Height YM1(mm)	475	Max Load (kg)	8	Robot Size (L MAXxWXH)mm	3020x1610x2050
Vertical Stroke YM2(mm)	725	Dry Cycle Time(Sec)	7	Package Size (LxWxH)mm	3500x1800x2000

# SW6715DS

## SPECIFICATION

AXIS

03

SERVO

AC

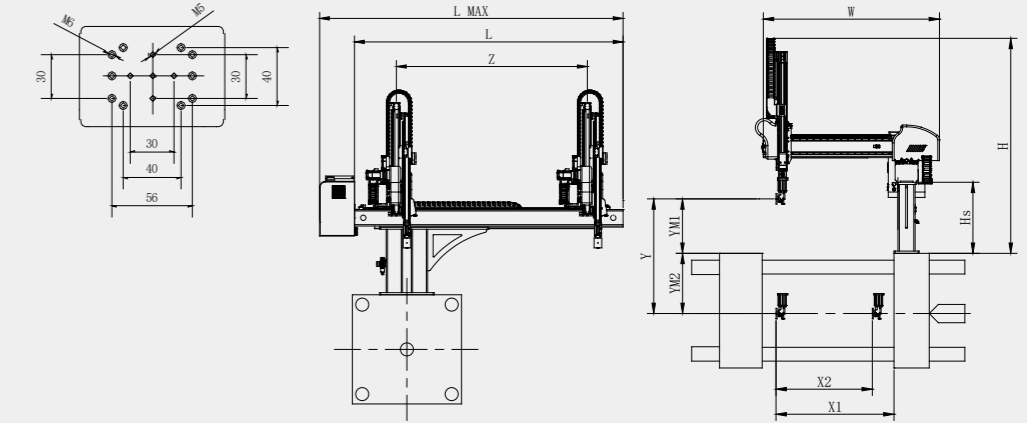

Recommended IMM (Ton)	500-1000	Reference Base Height Hs(mm)	700	AC IN PUT (V)	AC220
Traverse Stroke Z (mm)	2300	Servo Driver/Motor X	750W	Power(KVA)	6(Single Phase)
Vertical Stroke Y (mm)	1500	Servo Driver/Motor Y	2000W	Working Pressure(kgf/cm <sup>2</sup> )	5-7
Crosswise Stroke X2 (mm)	1180	Servo Driver/Motor Z	1000w	Air Consumption(NL/cycle)	2.8
Furthest Position Of Main Arm X1(mm)	1480	Vacuum	2	Language Selection	中 /EN/Other
Deputy Arm Stroke X4(mm)	-	Chuck pipe	2	Net Weight(kg)	1400
Nearest Position Of Secondary Arm X5(mm)	-	Take Out Time(Sec)	3.2	Gross Weight(kg)	1440
Standby Height YM1(mm)	450	Max Load (kg)	15	Robot Size (L MAXxWXH)mm	3120x2350x2400
Vertical Stroke YM2(mm)	1050	Dry Cycle Time(Sec)	7	Package Size (LxWxH)mm	3500x2200x2000

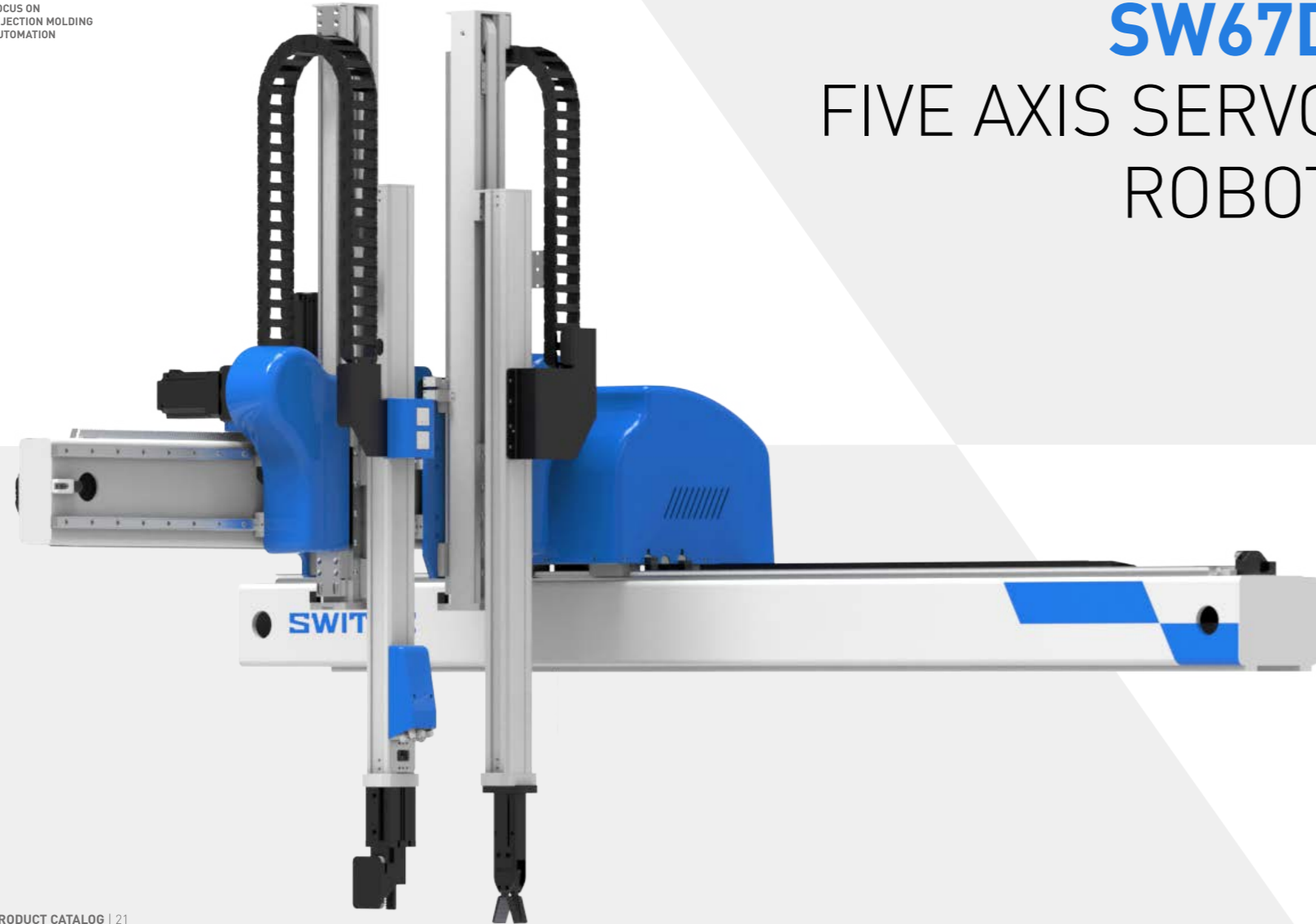

# SW67D

## FIVE AXIS SERVO ROBOT

# SW6710D-20

## SPECIFICATION

AXIS

**05**

SERVO

**AC**

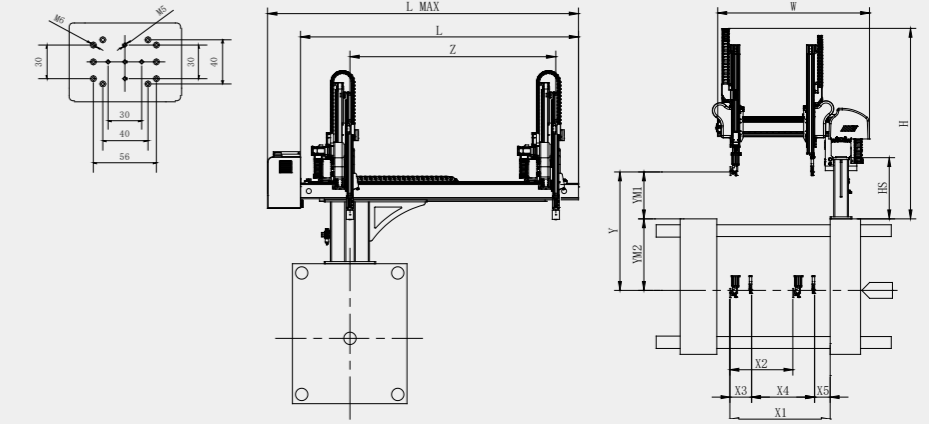

Recommended IMM (Ton)	100-350	Reference Base Height Hs(mm)	620	AC IN PUT (V)	AC220
Traverse Stroke Z (mm)	1750	Servo Driver/Motor X	400x2W	Power(KVA)	4(Single Phase)
Vertical Stroke Y (mm)	1000	Servo Driver/Motor Y	750x2W	Working Pressure(kgf/cm <sup>2</sup> )	5-7
Crosswise Stroke X2 (mm)	605	Servo Driver/Motor Z	750w	Air Consumption(NL/cycle)	3.5
Furthest Position Of Main Arm X1(mm)	1025	Vacuum	2	Language Selection	中 /EN/Other
Deputy Arm Stroke X4(mm)	590	Chuck pipe	2	Net Weight(kg)	550
Nearest Position Of Secondary Arm X5(mm)	170	Take Out Time(Sec)	3	Gross Weight(kg)	580
Standby Height YM1(mm)	475	Max Load (kg)	8	Robot Size (L MAXxWxH)mm	2780x1610x1930
Vertical Stroke YM2(mm)	525	Dry Cycle Time(Sec)	7	Package Size (LxWxH)mm	3200x1800x2100

# SW6712D-20

## SPECIFICATION

AXIS

05

SERVO

AC

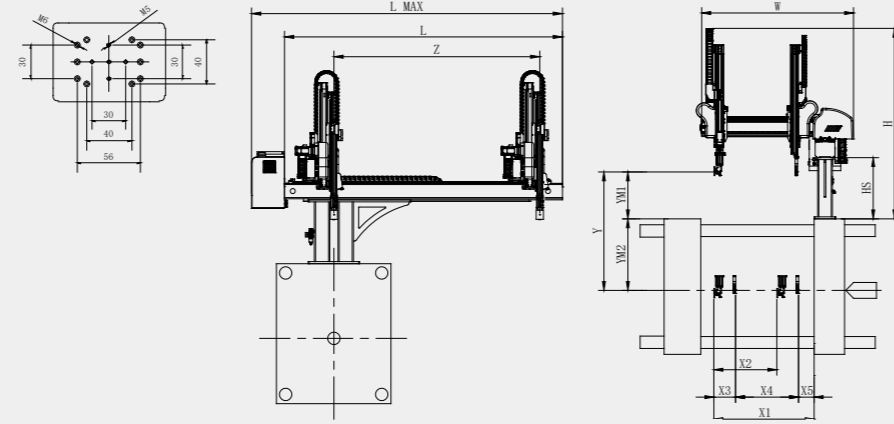

Recommended IMM (Ton)	350-650	Reference Base Height Hs(mm)	620	AC IN PUT (V)	AC220
Traverse Stroke Z (mm)	2000	Servo Driver/Motor X	400x2W	Power(KVA)	4(Single Phase)
Vertical Stroke Y (mm)	1200	Servo Driver/Motor Y	750x2W	Working Pressure(kgf/cm <sup>2</sup> )	5-7
Crosswise Stroke X2 (mm)	605	Servo Driver/Motor Z	750w	Air Consumption(NL/cycle)	3.5
Furthest Position Of Main Arm X1(mm)	1025	Vacuum	2	Language Selection	中 /EN/Other
Deputy Arm Stroke X4(mm)	590	Chuck pipe	2	Net Weight(kg)	570
Nearest Position Of Secondary Arm X5(mm)	170	Take Out Time(Sec)	3	Gross Weight(kg)	600
Standby Height YM1(mm)	475	Max Load (kg)	8	Robot Size (L MAXxWxH)mm	3020x1610x2050
Vertical Stroke YM2(mm)	725	Dry Cycle Time(Sec)	7	Package Size (LxWxH)mm	3500x1800x2000

# SW6715D

## SPECIFICATION

AXIS

05

SERVO

AC

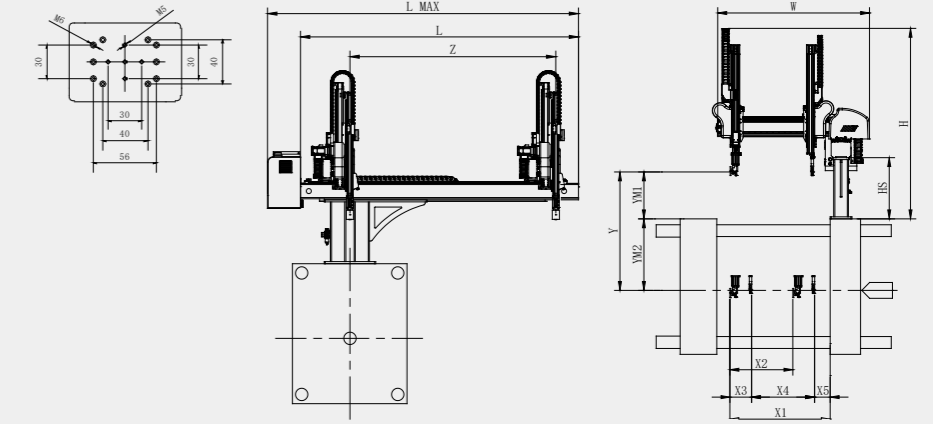

Recommended IMM (Ton)	500-1000	Reference Base Height Hs(mm)	700	AC IN PUT (V)	AC220
Traverse Stroke Z (mm)	2300	Servo Driver/Motor X	750x2W	Power(KVA)	8(Single Phase)
Vertical Stroke Y (mm)	1500	Servo Driver/Motor Y	2000x2W	Working Pressure(kgf/cm <sup>2</sup> )	5-7
Crosswise Stroke X2 (mm)	734	Servo Driver/Motor Z	2000w	Air Consumption(NL/cycle)	3.8
Furthest Position Of Main Arm X1(mm)	1480	Vacuum	2	Language Selection	中 /EN/Other
Deputy Arm Stroke X4(mm)	734	Chuck pipe	2	Net Weight(kg)	1500
Nearest Position Of Secondary Arm X5(mm)	230	Take Out Time(Sec)	3.2	Gross Weight(kg)	1540
Standby Height YM1(mm)	450	Max Load (kg)	15	Robot Size (L MAXxWxH)mm	3120x2350x2400
Vertical Stroke YM2(mm)	1050	Dry Cycle Time(Sec)	7	Package Size (LxWxH)mm	3500x2200x2000



# FOCUS ON INJECTION MOLDING AUTOMATION

专注于注塑自动化

## SWITEK TECHNOLOGY AUTOMATION CO., LTD

+86 769-8239-8229  
+86 186-6687-8722

FAX: +86 769-8185-9017  
E-MAIL: SALES@SWITEK.COM.CN

## SWITEK (NINGBO) TECHNOLOGY CO., LTD.

+86 574-8682-1700  
+86 186-6517-1961

FAX: +86 574-8682-1700  
E-MAIL: SALES@SWITEK.BIZ

Nanwei Industrial District, Chashan Town, DongGuan,  
GuangDong Province, P.R.China

No.491, West MingZhou Road, BeiLun,  
NingBo City, P.R.China